

Sustainable CT

Local Actions. Statewide Impact.®

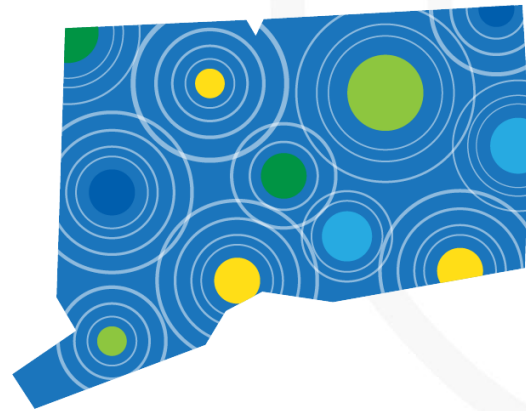

Sustainable CT

Supporting and Celebrating Sustainability
Initiatives in CT Communities

November 2023

Sustainable CT

1. Program Overview
2. Roadmap of Actions
3. Certification
4. Technical Assistance and Funding
5. Impact and Benefits
6. Get involved
7. Resources for Your Work

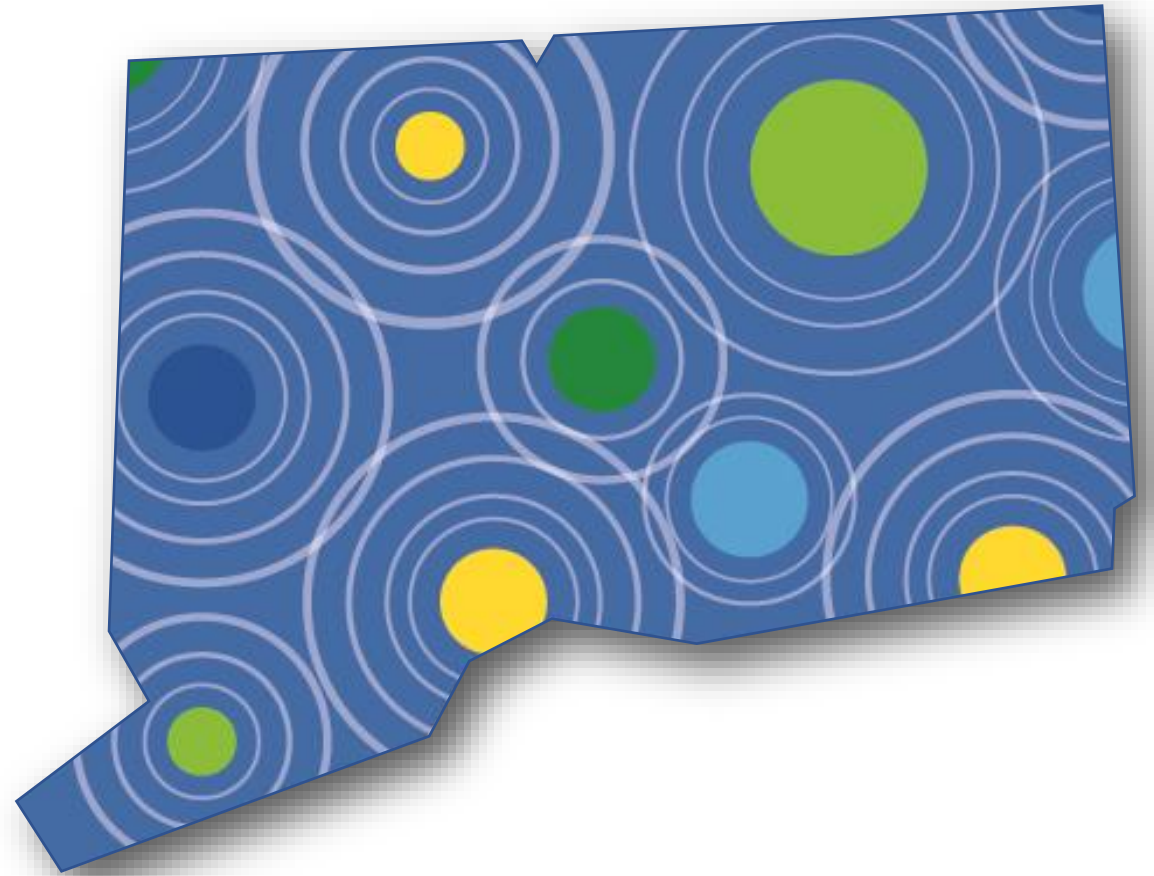

Advancing Sustainability Through...



Roadmap

- Menu of sustainability actions



Resources

- Technical assistance and funding



Certification

- Recognition and celebration of achievements



Roadmap of Actions

Roadmap of Voluntary Actions

1. Inclusive and **equitable community** impacts
2. Thriving **local economies**
3. Well-stewarded **land and natural resources**
4. Vibrant and creative **cultural ecosystems**
5. Dynamic and resilient **planning**
6. Clean and diverse **transportation** systems
7. Renewable and efficient **energy infrastructure and operations**
8. Inclusive **engagement, communication and education**
9. Strategic **materials management**
10. Optimal **health and wellness** opportunities
11. Healthy, efficient, and diverse **housing**
12. Effective, compassionate **homelessness prevention**
13. Innovative **strategies and practices**



What Does Action Look Like?

Examples of the 200+ Qualifying Possibilities

- Purchasing of sustainable goods and services
- Watershed protection programs
- Arts and culture initiatives
- Inventory and assessment of historic resources
- Pro-sustainability permitting process
- Agriculture friendly practices
- Energy use reduction across municipal buildings
- Healthy and sustainable food networks
- Housing needs assessment

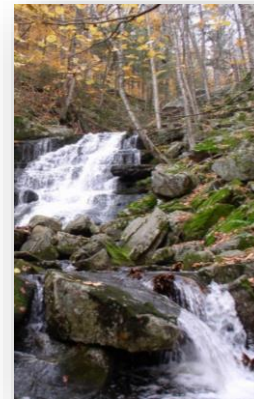

Action Example

Action 3.1: Provide Watershed Education

- Provide watershed education to residents and business owners
 - Sponsor or host an education program
 - Implement and maintain a watershed signage program
 - Encourage residents and business owners to take a watershed health pledge
- Institute a local monitoring program related to watershed functions or health to be conducted by citizen groups



Action Example

Action 3.2: Create a Watershed Management Plan

- Conduct a watershed inventory
- Conduct a regulation review and alignment with watershed protection goals
- Based on your completed inventory and regulation review, develop a management plan



Watershed Resources

Action 3.3: Engage in Watershed Protection and Restoration

- Complete a priority project as ideally outlined in your Watershed Action Plan, such as riparian restoration or monitoring
- Adopt or revise regulations to help protect ecologically important areas such as source waters, tidal wetlands, riparian corridors, vernal pools, critical habitat areas, etc.



Action Example

Action 3.4: Develop an Open Space Plan

- Develop an Open Space Plan
- Complete an open space inventory using the Sustainable CT template
- Protect open space
 - Increase preserved open space in your community
 - Establish an open space acquisition fund



Action Example

Action 3.8 Implement Low Impact Development

- Develop and distribute educational materials on LID practices, such as bioswales, bioretention/rain gardens, stormwater wetlands, green roofs, permeable pavement
- Encourage and promote LID in your municipal ordinances and/or regulations



Action Example

Action 3.9: Manage Woodlands and Urban Forests

- Complete a review of your municipal policy, priorities, and practices on woodlands and urban forests
- Complete a Forest Management Plan
- Implement at least two best practices and programs to manage and create equitable and sustainable woodlands and urban forests



Action Example

Action 3.10: Facilitate Invasive Species Education and Management

- Promote Invasive Species Management by examining your municipalities regulations and embedding invasive species management practices into your maintenance program
- Engage in invasive species management practices on municipal properties and in local waterbodies
- Educate residents on invasive species



Action Example

Action 3.12: Enhance Pollinator Pathways

- Provide education to residents and local businesses to improve pollinator habitat
- Create native pollinator gardens, upgrade existing gardens to be pollinator friendly and educate the public about the importance of pollinators to society
- Pass a Native Pollinator Friendly Community resolution



Action Example

Action 3.13 Promote Dark Skies

- Conduct education and outreach related to light pollution for local businesses, institutions, and residences
- Adopt a policy to analyze lighting needs at municipal facilities to reduce light pollution
- Require all projects to have dark sky compliant fixtures



JOIN US IN TURNING OFF NIGHTTIME LIGHTS

Lights Out, Goshen!

Save migratory birds, support nocturnal animals, and conserve energy!

Be a good neighbor!
Dim or turn off exterior lights when not needed at night.

WHY?	HOW?
<ul style="list-style-type: none">• Support local ecosystems! Excess lighting can confuse animals' sense of direction, and disrupt mating and hunting behaviors.• Conserve energy and save money!• Reducing ambient light can help you and your neighbors sleep better too!	<ul style="list-style-type: none">• Turn off exterior lighting.• Turn off interior lighting or pull window coverings.• Down-shield exterior lighting to eliminate horizontal glare and all light directed upward• Install automatic motion sensors and controls• Avoiding over-lighting with newer, brighter technology when getting new bulbs

LEARN MORE AT WWW.AUDUBON.ORG/LIGHTS-OUT-PROGRAM

Action Example

Action 5.1 Integrate Sustainability into Plan of Conservation and Development

- Include at least four Hazard Mitigation Plan goals into your POCD
- Incorporate at least three sustainability concepts as policy
- Engage in intentional and ongoing public outreach and participation on planning issues



Action Example

Action 5.3: Develop Agriculture-Friendly Practices

- Adopt land use policies and regulations that promote and support active agricultural uses
- Promote community access to land for farming and agricultural uses
- Develop a Transfer or Purchase of Development Rights program
- Hold a farmer forum to identify critical needs or issues for agriculture in municipality



Action Example

Action 9.4: Reduce and Compost Organic Waste

- Implement an ongoing food waste prevention campaign
 - An educational campaign that prevents the creation of food waste in schools and resident's homes
- Implement a program to divert food waste or other non-mandated organic waste



The background features three sets of concentric circles. The top-right set has a yellow center, the bottom-right set has a blue center, and the bottom-left set has a green center. The word "Certification" is written in blue text, overlapping the green circle and its surrounding rings.

Certification

Certification



2023 Bronze Certification Requirements

Complete **1 Equity Toolkit** in Action [Optimize for Equity](#).

Complete at least **1 action** in each of the categories (2-12).

Successfully complete actions totaling **200 or more points**.



2023 Silver Certification Requirements

Complete **3 Equity Toolkits** in Action [Optimize for Equity](#).

Complete at least **1 action** in each of the categories (2-12).

Successfully complete actions totaling **500 or more points**.



2023 Gold Certification Requirements

Complete **all actions** in Category 1, Inclusive and Equitable Communities, including **4 Equity Toolkits** in Action [Optimize for Equity](#).

Complete at least **1 action** in each of the categories (2-12).

Achieve [Climate Leader Designation](#).

Complete Action 8.6, [Collaborate with Other Municipalities on Sustainability Actions](#).

Successfully complete actions totaling **750 or more points**.

Climate Leader Designation

- The Climate Leader Designation is an add-on to certification, showcasing towns that complete high impact actions that reduce GHG emissions and build resilience
- Municipality can choose any combination of Climate Leader actions to earn 150 points

Goals:

- Create high visibility around climate action within the Sustainable CT framework
- Accelerate municipal implementation of high-impact actions that reduce harmful GHG emissions and prepare communities for the impacts of climate change
- Advance and align with state climate goals through collective municipal action



Recognition





Resources

Support and Technical Assistance



Equity Coaches



Workshops, Training



Technical Assistance Partners



Fellowship Program

Community Match Fund

- Fast, easy, flexible, no deadlines
- Anyone with a good idea to improve their community
- Crowdfunding doubled by **\$1-to-\$1** matching grant from Sustainable CT
- Up to **\$7,500** from matching grant
- Coaching and support for project leaders
- Over **\$3.5 million** invested in almost 300 community-led projects statewide

supported by **Sustainable CT**
Local Actions. Statewide Impact.

Send a Kid to Farm and Forest Camp!

Help Everyone Outside provide busses and more financial aid!

Facebook Twitter Email 3

Portland, CT Causes Education
Community Food & Agri

\$7,387
funded of \$7,500 goal

88
patrons

1
day left

Support

Sustainable CT
Local Actions. Statewide Impact.

This campaign is eligible for a grant from **Sustainable CT**

Story Updates Donors

Nature Connection should be for Everyone!

Central Connecticut non-profits **Everyone Outside** and **Fire Ring Farm** have teamed up to create a welcoming space for kids to spend time outside learning about our beautiful natural...

PARTIAL FUNDING
This campaign will collect all funds raised by Jun 10, 2022 12:00 PM.

Foote Riverside Park Pollinator Garden Branford

The third grade students at Mary R. Tisko School planned and planted a Pollinator Garden at Foote Riverside Park on Pine Orchard Road in Branford, CT.

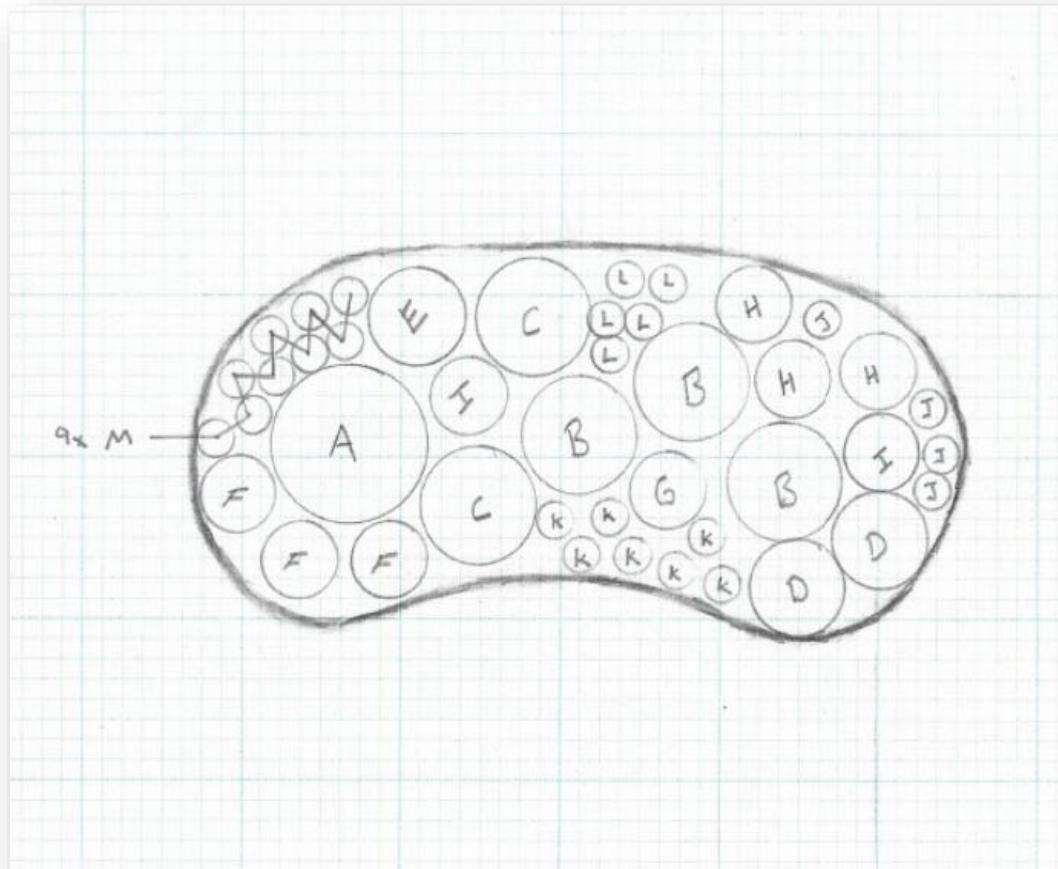

Cheshire Pollinator Pathway Project

Cheshire

Led by the Coalition for a Sustainable Cheshire, the group of volunteers expanded on their pollinator pathway project from 2021 to create a new pollinator garden, develop signage, remove invasive species and create educational materials and events for the public



Long Lots Preserve *Westport*

This multi-phase project established densely planted native flora surrounding the Westport Community Gardens to complete the transformation of public land to an ecologically rich model of suburban open space rehabilitation.

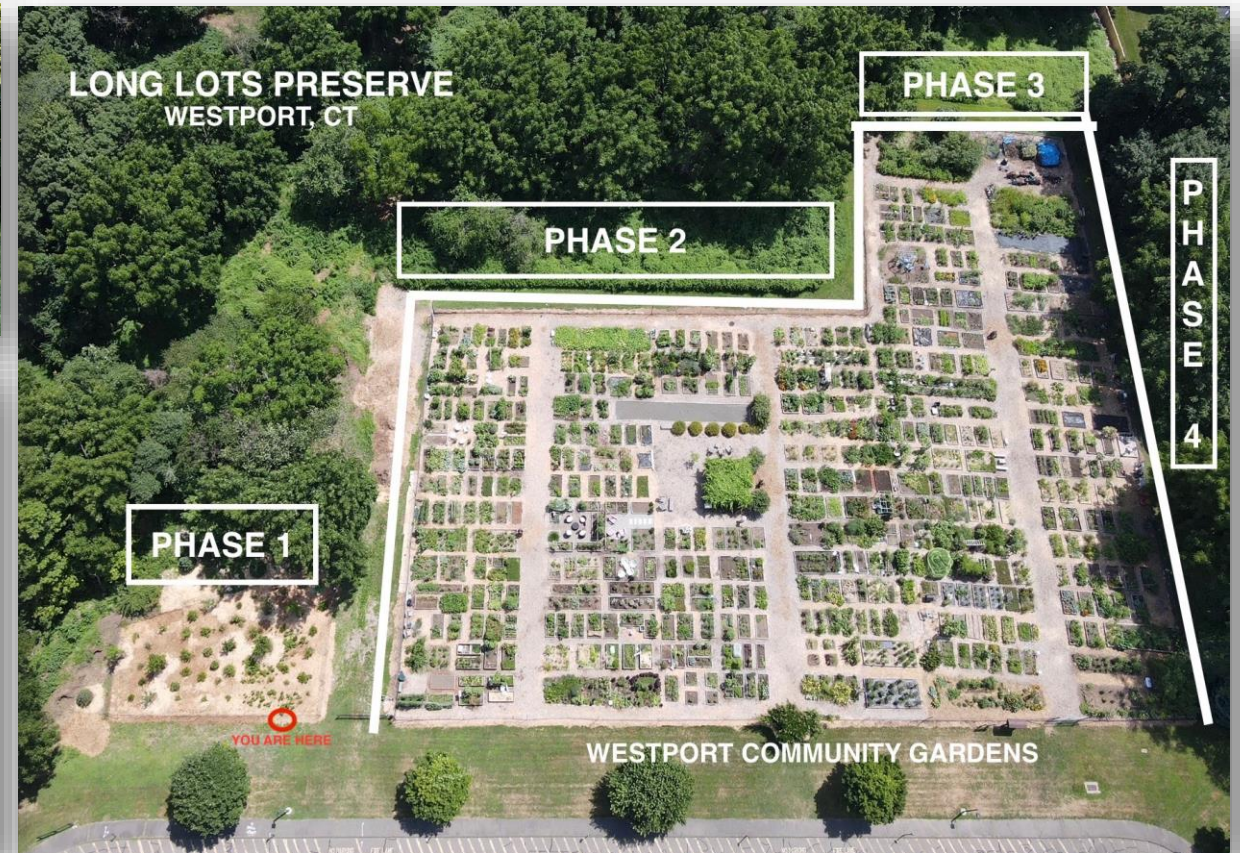
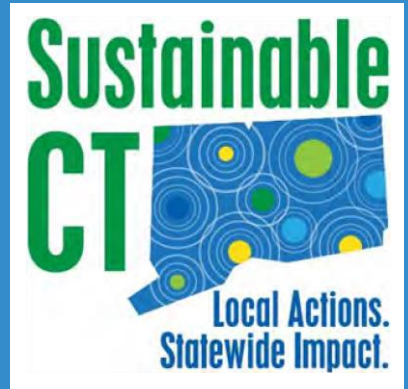

Native Plant Pollinator Garden at Lake Mohegan *Fairfield*

Led by a junior at Fairfield Warde High School, a 35' x 5' garden of native plants to help support the local ecosystem and serve as a haven for native plants, insects, and birds



Preserving the Herman E. Sheets Family Forest

North Stonington

Led by Avalonia Land Conservancy, this project was able to secure the final funds needed to permanently preserve the Herman E. Sheets Family Forest, a gorgeous 86-acre property in North Stonington in the historic settlement area of Laurel Glen.

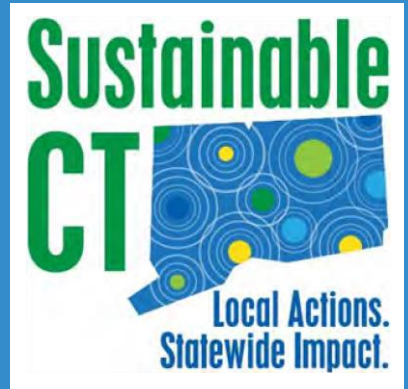

Horton Cove Trail Eagle Scout Project

Montville

Led by Tyler Lawton, Eagle Scout of Troop 93, this project increased access to the many benefits of outdoor recreation in a safe and environmentally-friendly way by creating a citizen-friendly and educational trail.



Tri-Town Region 4 Food Scrap Composting and Education Campaign

Essex, Deep River, and Chester

Led by sustainability commission members from each town, the project raised enough fund to provide all 5 of the Region 4 schools with enough funding to cover the cost of food scrap hauling for the next two school years! Project Leaders also hope to run a joint community wide educational campaign on composting and recycling.

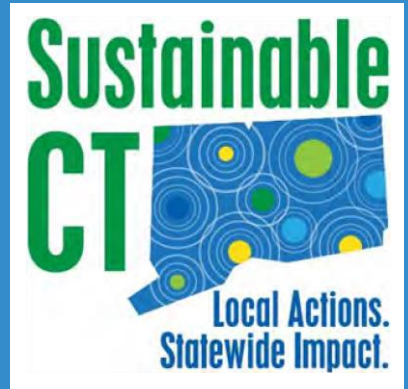

Suffield Food Waste Diversion Initiative

Suffield

Led by the Suffield Sustainability and Energy Task Force, this project aims to provide the community with a food scrap/organic waste collection bin and provide a pilot group of residents at-home compost bins.



The West Hartford Tree Project

West Hartford

The West Hartford Tree Project has raised money to purchase young native tree seedlings from the CT Conservation District and distribute them directly and free of charge to West Hartford residents, culminating in the planting of over 3,000 tree seedlings.



Trees for Windsor Locks

Windsor Locks

Led by the Town of Windsor Locks, this project preserved, planted, sustained, and celebrated the trees of Windsor Locks through educational activities, community events, plantings, and tree care.



Restoring New Milford's Great Brook

New Milford

The Town of New Milford and volunteers worked to remove years of accumulated rubbish and invasives that crowd out native species, while strengthening the banks of Great Brook, a Housatonic River tributary.



Friends of North Cove Salt Marsh Habitat Restoration

Old Saybrook

Friends of North Cove worked to remove invasive phragmites from the North Cove salt marshes and restore the area as a natural habitat for birds and other wildlife to nest and feed.



Park Challenge 2021 - Riverfront Recapture

Hartford

Project leaders repaired the parks daylily beds by pulling out invasives, cleaning up the garden beds, and replanting these lovely, vibrant flowers.



Invasive Species Removal for Tree Health

New Haven

Led by New Haven Urban Resources Initiative, volunteers and green job crews worked to remove invasive vines threatening the health of New Haven's trees.



New Haven Climathon

New Haven

Funding the New Haven Climathon, a community gathering aimed at raising awareness about the local impacts of climate change and catalyze action.

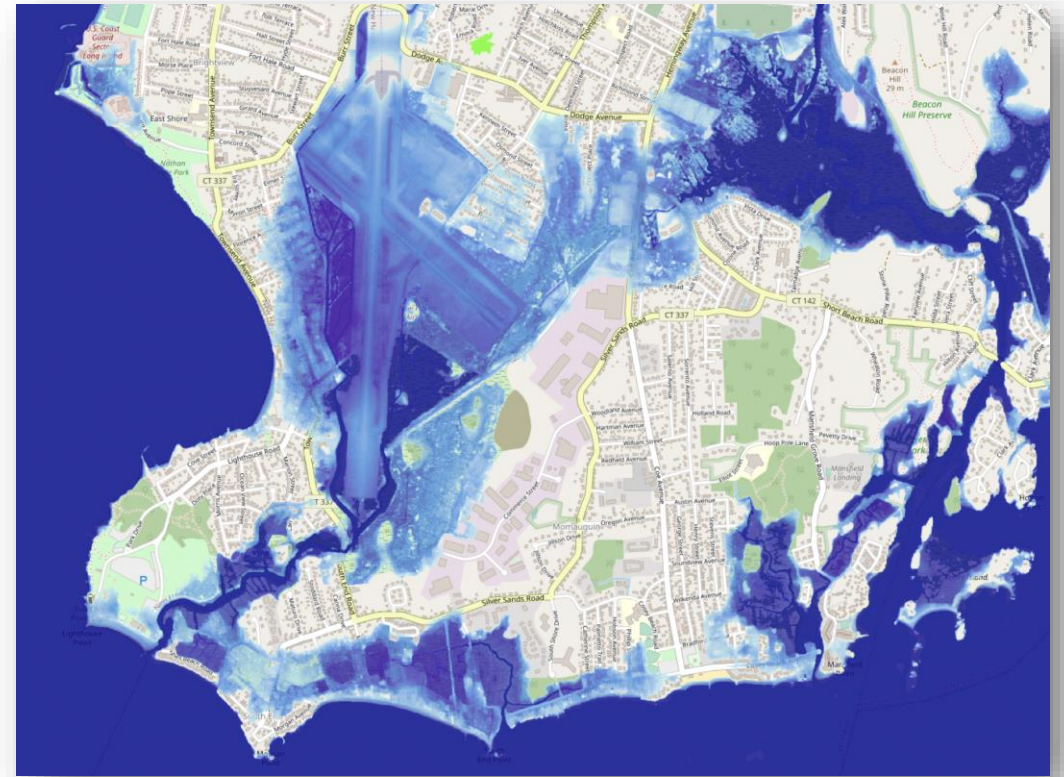

The background features three sets of concentric circles. The top-right set has a yellow center, the bottom-right set has a blue center, and the bottom-left set has a green center. The text 'Impact and Benefits' is centered horizontally and partially overlaps the green circle.

Impact and Benefits

Impact

- **131** CT towns participating (78%)
- **68** towns certified
- **11** Climate Leaders
- More than **3,328** sustainability actions implemented
- Over **\$3.5 million** invested in community-led projects
- Connected, inclusive, resilient communities

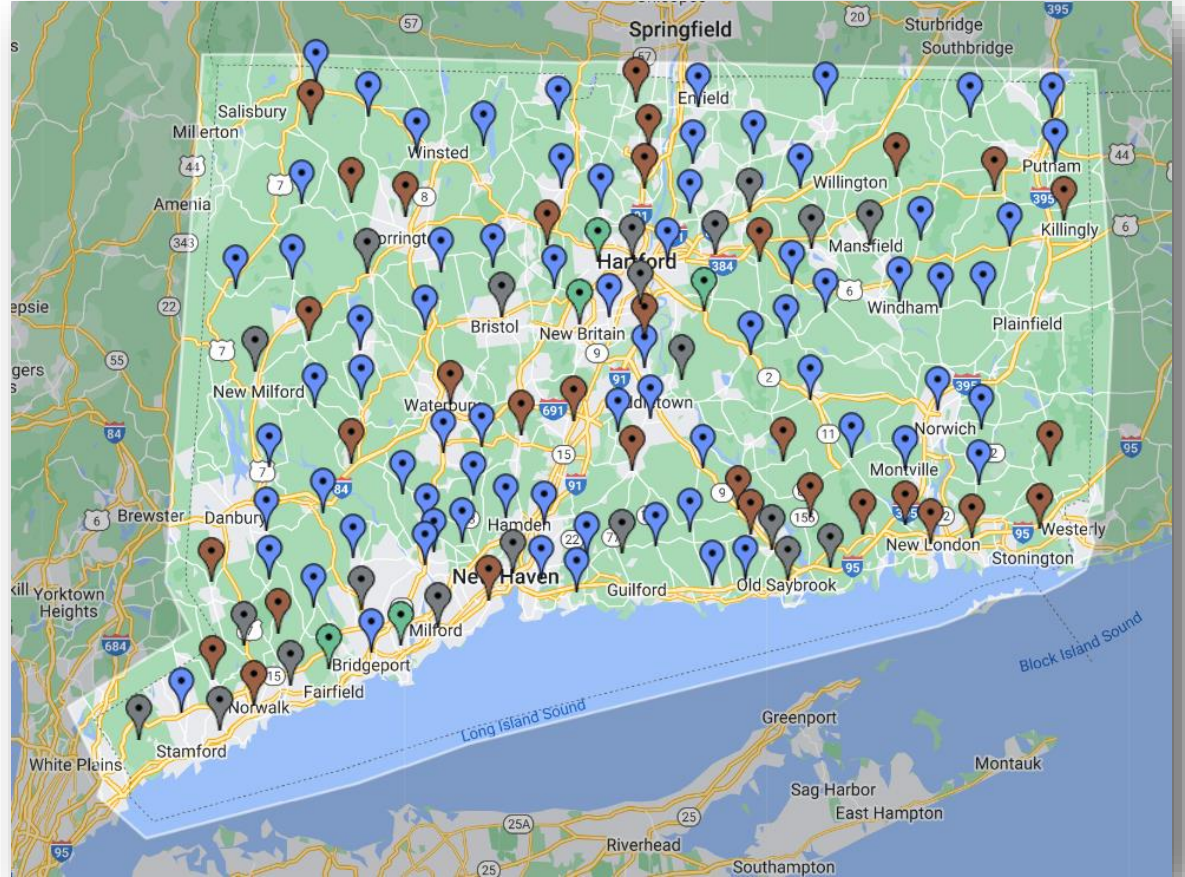

Benefits



“We are proud to see Hartford recognized once again with a Sustainable CT silver-level certification... and I want to thank Sustainable CT for their leadership in building a more sustainable Connecticut.”

—Mayor Luke Bronin, Hartford

- Protects the environment and reduces greenhouse gases
- Saves money
- Provides a rallying point and collective vision
- Offers access to matching funds for projects
- Recognizes/showcases your accomplishments and commitment to sustainability
- Promotes civic pride
- Attracts new business, smart development, a skilled workforce and new families



“Thanks to Sustainable CT’s jump-start, I Heart My Home CT is assisting other agencies and municipalities to meet their residential energy efficiency targets.”

—Kathy Fay, Director of Community Sustainability, NHS New Haven



“The [Equity] Coach helped us sharpen our focus on reaching out to the East Hartford community, to gain input and suggestions of individuals who may be underserved.”

—Tom Baptist, Director of Public Works, East Hartford



“This fellowship gave me a unique professional experience at the intersection of nonprofit work and municipal government.”

—Adrian Huq, 2022 Sustainable CT Fellow with Naugatuck Valley Council of Governments



Resources for Your Work

Sustainable CT: Resources for Your Work

- Sustainable CT actions
 - Best practice guides that include helpful resources and success stories
 - Help your community earn points towards certification
- Community Match Fund
 - Open to anyone in a registered Sustainable CT community
- Sustainable CT No-Cost Assistance programs
 - Open to all registered Sustainable CT communities
- Sustainable CT event calendar

Thank you, Sustainable CT Funders



Tremaine Foundation



COMMONSENSEFUND



Community Foundation
of Eastern Connecticut



NEW CANAAN
COMMUNITY
FOUNDATION



Thank you, Technical Assistance Partners



UCONN
SMARTBUILDINGS CT



METROCOG
Connecticut Metropolitan Council of Governments



HARTFORD FOOD SYSTEM

SCRCOG
SOUTH CENTRAL REGIONAL COUNCIL OF GOVERNMENTS



American Lung Association



Save the Sound[®]
Action for our region's environment.

CRCOG
CAPITOL REGION COUNCIL OF GOVERNMENTS
Working together for a better region.



Thank you, Technical Assistance Partners



Sustainable CT

Local Actions. Statewide Impact.®

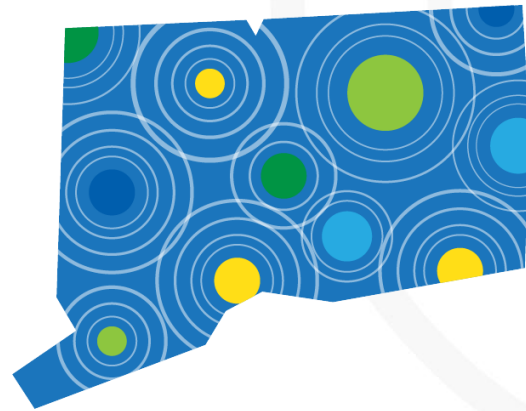

Jessica LeClair,

Senior Program Director

jessical@sustainablect.org

www.sustainablect.org